

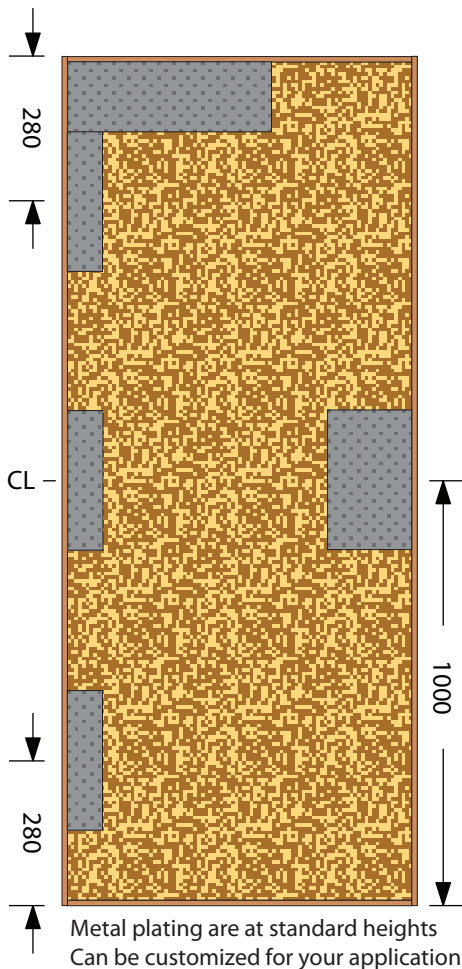

## Green Fire Doors



Spence Doors are FSC, PEFC & AFS accredited and can offer fire doors which satisfy the GBCA Mat-8 Sustainable Timber credit requirements.

### CORE MATERIAL

- Fire Rated Core (example rating)

### ABBREVIATIONS

(1HR)

### STANDARD THICKNESSES (nominal)

- 37mm Residential
- 47mm Commercial

(MINI)

(MAXI)

### DOOR FACE OPTIONS

- MDF (paint quality)
- Plywood (paint quality)
- Select Veneer (will depend on veneer specified)

(MDF)

(PQ PLY)

### INTERNAL EDGE STRIPS ONLY

- All round (this is standard)

(INT-ES)

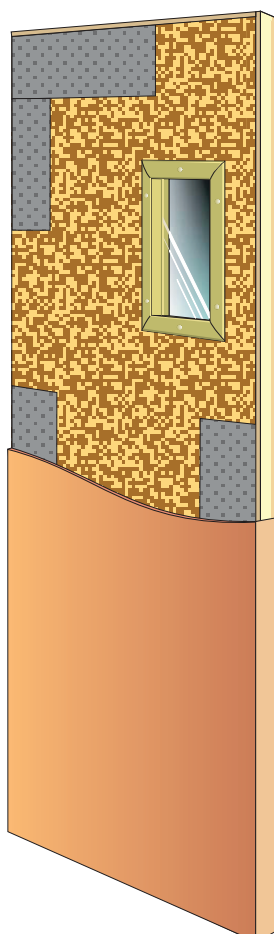

Viewing panel  
(OPTIONAL)

Standard Sizes:  
600x100  
300x200  
400x150

### Specifying Door Types:

-Spence Green Fire Door - 1HR - MAXI - PQ PLY - INT-ES



Part of the Spence 'Green Door' Range